

# LANGLEY

THE ESTATES AT  
**CLYDESDALE BEND**  
• 2300 W. 560 S. Provo •

- 2,233 sq. ft.  
(2,656 sq. ft. with optional bonus room)
- 4 bedrooms
- 2 ½ baths
- 2-car garage

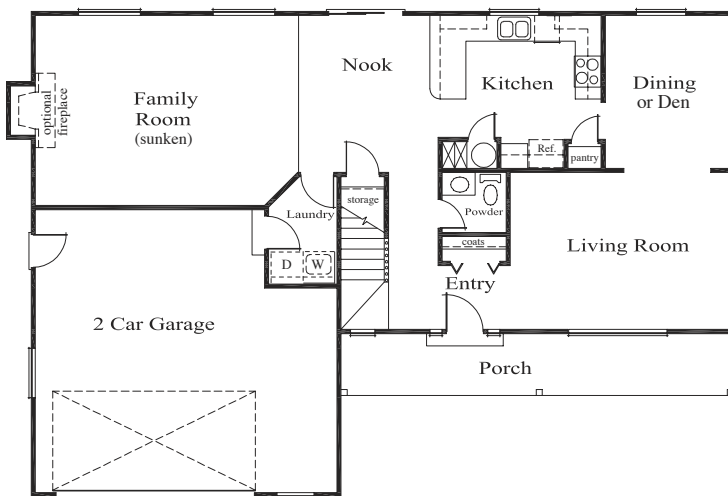

Main Floor  
1273 sq. ft.

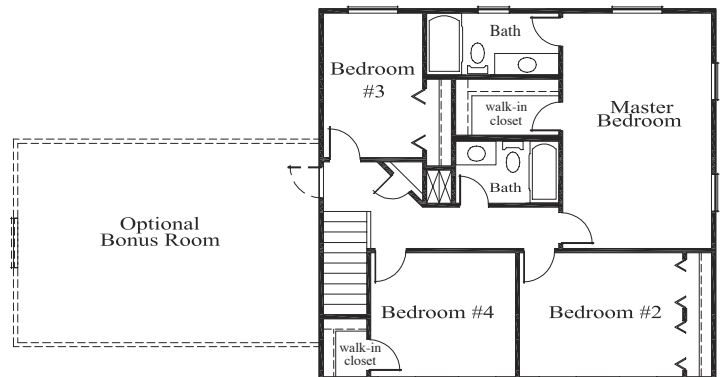

2nd Floor  
960 sq.ft.  
(1373 sq. ft. with bonus room)

DEAN INGRAM OR STEVE MADDUX  
801-318-9569 801-602-9839

# LANGLEY FEATURES

## Luxury & Convenience

- 4 bedrooms, 2 ½ baths
- Formal dining & living rooms
- Breakfast nook
- Kitchen open to family room
- 2 car garage with garage door opener
- Hardwood railing on stairs
- Covered front porch
- Pre-wired for telephone, cable TV, and Cat V computer networking
- Main floor laundry/utility room
- Main floor powder room (½ bath)
- Master bathroom soaking tub/shower

## Bathrooms

- Alder or birch raised panel vanity cabinets
- Laminate countertops with self-rimming sinks
- Full width mirrors above vanities
- Moen plumbing fixtures

## Kitchen

- Alder or birch raised panel cabinets
- Laminate countertops
- Dishwasher
- Smooth top range
- Microwave/hood
- Disposal
- Pantry

## Quality

- Individually styled exterior
- Low-maintenance exterior: brick or stone & SmartSide siding
- Raingutters & downspouts
- Metal or fiberglass exterior doors
- Concrete patio
- 30 year asphalt shingles
- Kickplate on front door
- Thumbblatch & deadbolt on front door
- Nickel interior door handle sets
- Rounded drywall corners
- Vinyl frame double pane windows
- Insulated exterior doors
- R-38 attic insulation
- R-19 wall insulation
- 80% efficient gas furnace

## Optional Features

- Fireplace in family room
- Additional brick, stucco or stone on exterior (standard Langley plan includes brick or stone & SmartSide siding)
- Central Air Conditioning
- 2nd floor bonus room over garage

*Generous flooring, lighting, appliance and cabinet allowances are included in the price of the home.*

*Georgetown homes feature fine quality in every respect. Standard plans can be modified to accommodate your individual needs. We build each home to be customized for the buyer and welcome your input when designing your home.*

**GEORGETOWN**

• Development •

[www.georgetowndevelopment.com](http://www.georgetowndevelopment.com)



**Affiliated**

REALTY GROUP

[www.myhomeutah.com](http://www.myhomeutah.com)

*The builder reserves the right to make changes and substitutions as necessary. Illustrations are for the purposes of marketing only. May 4, 2009*